

1. Assign a location for the equipment considering the impact area (free/falling space requirement).
2. Excavate soil for foundation, according to drawing. Please note: To achieve maximum stability and a safe installation, a moderate level of soil solubility is required.
3. Grout foundation with compressed concrete C20/25, insert foundation anchorage into concrete according to drawing and align with spirit level. Insert foundation anchorage into concrete **at same level with top edge of foundation** (see detail).
4. After concrete foundation has set, screw bearing house onto foundation anchorage: flange of bearing - washer - cap nut M16 prevailing torque type.
Attention! For installation of the pre-assembled components and/or single parts the screws have to be lubricated with installation paste!
5. Afterwards remove the transport locking screw and close the hole with the attached plug.

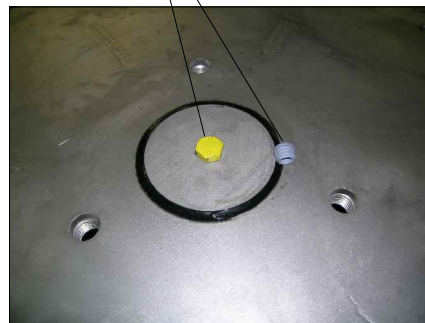

6. Remove the roundabout disk from the transport supporting fixture, mount it onto bearing housing acc. to drawing.
7. Due to forced movement, it is essential to cover the impact area with a shock- absorbing surface which meets the requirements for a critical fall height of at least 1000 mm (acc. to EN 1176-5).
8. Check all screw connections according to maintenance instructions after 4-5 weeks and retighten, if necessary.

Please take care that all special tools (e.g. special Allen key for secured Allen screws etc.) and all specific documents which are or may be useful for safety management acc. to EN 1176-7 (e.g. invoice, delivery note, order acknowledgement, installation instructions, maintenance instructions) are forwarded to the responsible persons.

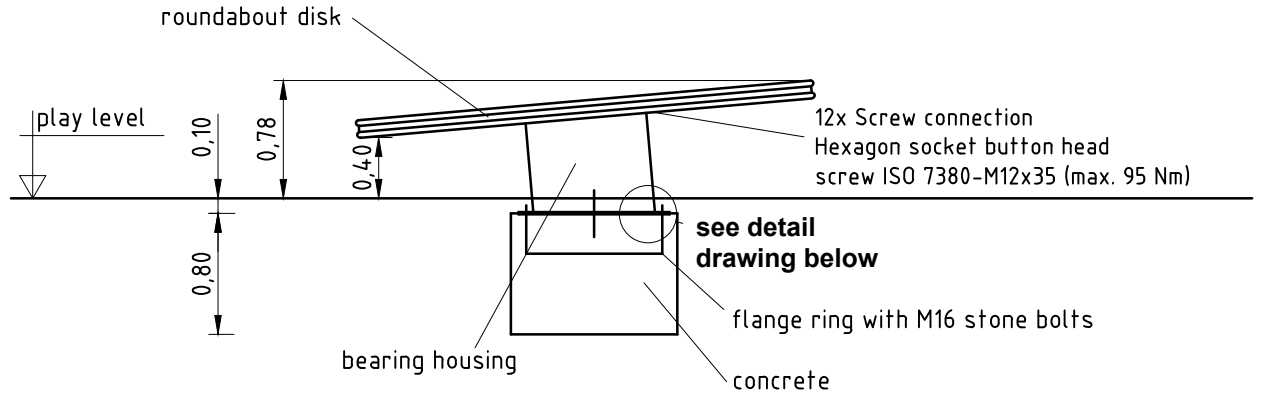

impact area (approx. 65 m²)
to be covered with impact
absorbing surfacing

foundation anchorage 1:10

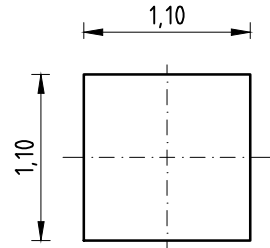
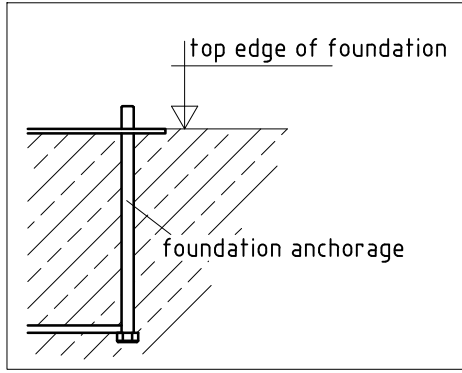

9,05

Installation

Item-No.	Description	Scale	Date	Page
0-43530-000	K&K Dutch disc (3,00)	1:50	03/14 EB	2/2