

1. Assign a device location considering the space requirements (impact area).
2. Excavate soil for foundations, according to drawing.
Please note: To achieve maximum stability and a safe installation, a moderate level of soil solubility is required.
3. Place posts into the respective foundation hole. Play level mark (=pin) complies with the installation depth.
4. **For installation of the pre-assembled components and/or single parts, the screws slightly have to be lubricated with installation paste!
Tighten all screws after having aligned all components.**
5. Grout foundations with compressed concrete C20/25, chamfer and round off the edges, cover the foundations with a surface which meets the requirements for impact attenuation so that the critical fall height of the surfacing is equal to, or greater than, the free height of fall of the equipment (acc. to EN 1176-1).
6. Release for play after concrete foundations have set.
7. According to maintenance instructions, check all screw connections after 4-5 weeks and retighten, if necessary.

Please ensure that all special tools supplied (e.g. Allen key for secured Allen screws etc.) and all specific documents which are or may be useful for safety management acc. to EN 1176-7 (e.g. invoice, delivery note, order acknowledgement, installation instructions, maintenance instructions) are forwarded to the persons responsible.

**Necessarily insert all attachment parts before tightening the screws.
It is NOT possible to insert them afterwards.**

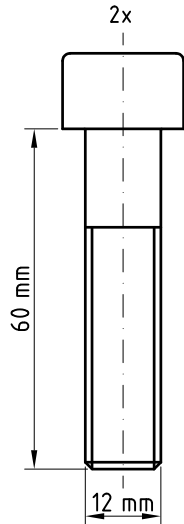

cylinder screw DIN 912 - M12x60 - A2;

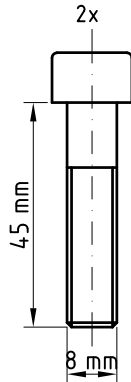

cylinder screw DIN 912 - M8x45 - A2;

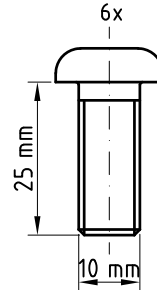

oval-head security screw - M10x25 - A2

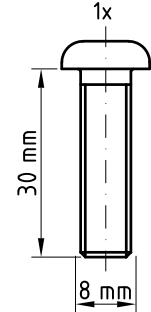

oval-head security screw - M8x30 - A2

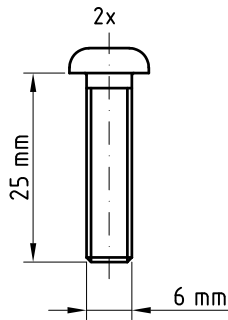

oval-head security screw - M6x25 - A2

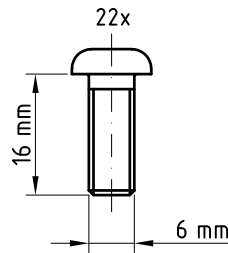

oval-head security screw - M6x16 - A2

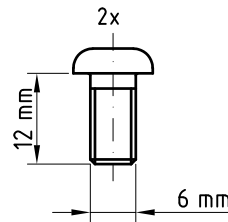

oval-head security screw - M6x12 - A2

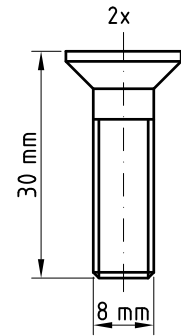

countersunk security screw - M8x30 - A2

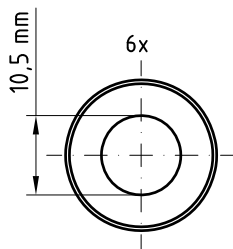

washer DIN 125 - Ø10,5 - A2

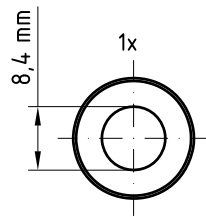

washer DIN 125 - Ø8,4 - A2

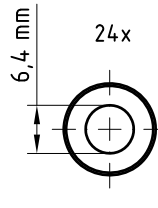

washer DIN 125 - Ø8,4 - A2

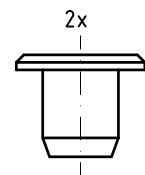

RAMPA round nut type RF - M8

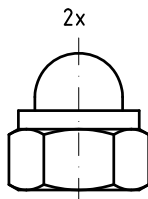

locking cap nut DIN 986 - M12 - A2

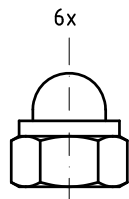

locking cap nut DIN 986 - M10 - A2

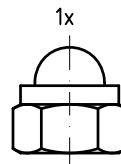

locking cap nut DIN 986 - M8 - A2

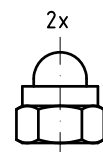

locking cap nut DIN 986 - M6 - A2

1x screw connection:

consisting of:

- 2x oval-head security screw - M6x12 - A2;
- 1x oval-head security screw - M8x30 - A2;
- 1x washer DIN 125 - ϕ 8,4 - A2;
- 1x locking cap nut DIN 986 - M8 - A2;
- 2x oval-head security screw - M10x25 - A2;
- 2x washer DIN 125 - ϕ 10,5 - A2;
- 2x locking cap nut DIN 986 - M10 - A2;

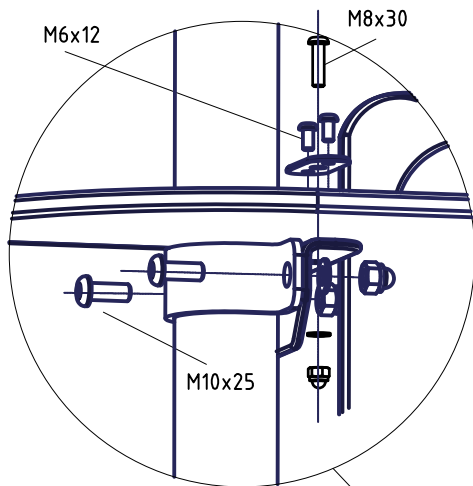

installation: step 1

2x screw connection:

consisting of:

- cylinder screw with pin DIN 912 - M12 x 60 - A2;
- cylinder screw DIN 912 - M8 x 45 - A2;
- locking cap nut DIN 986 - M12 A2;

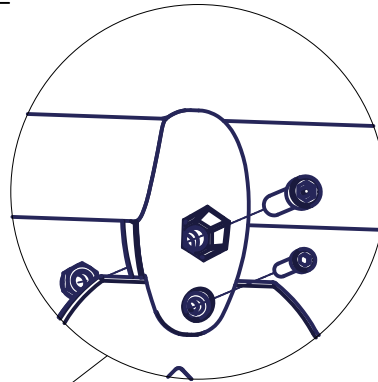

installation: step 2

2x screw connection:

consisting of:

- oval-head security screw - M6x16 - A2
- washer DIN 125 - ϕ 6,4 - A2;

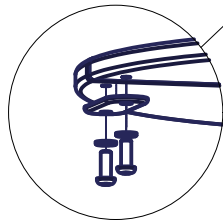

2x screw connection:

consisting of:

- 2x oval-head security screw - M6x16 - A2;
- 1x oval-head security screw - M6x25 - A2;
- 1x locking cap nut DIN 986 - M6 - A2;
- 3x washer DIN 125 - ϕ 6,4 - A2;

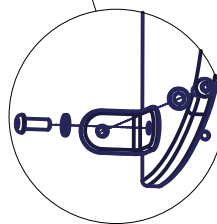

16x screw connection:

consisting of:

- oval-head security screw - M6x16 - A2;
- washer DIN 125 - ϕ 6,4 - A2

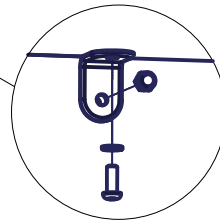

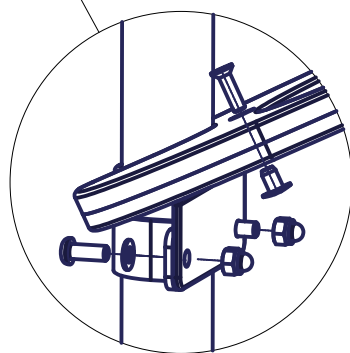
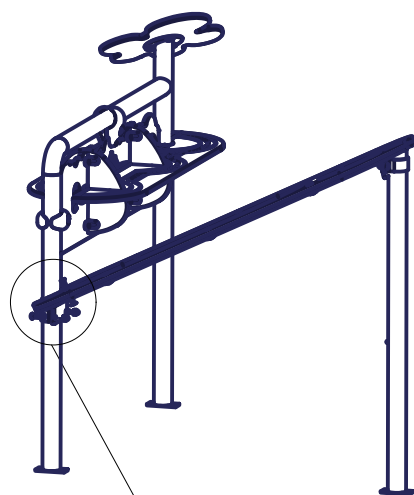

2x screw connection:

consisting of:

countersunk security screw - M8x30 - A2;
RAMPA round nut type RF - M8;

4x screw connection:

consisting of:

oval-head security screw - M10x25 - A2;
washer DIN 125 - ϕ 10,5 - A2;
locking cap nut DIN 986 - M10 - A2;

*max. free height of fall

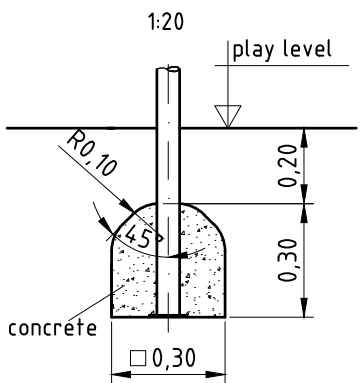
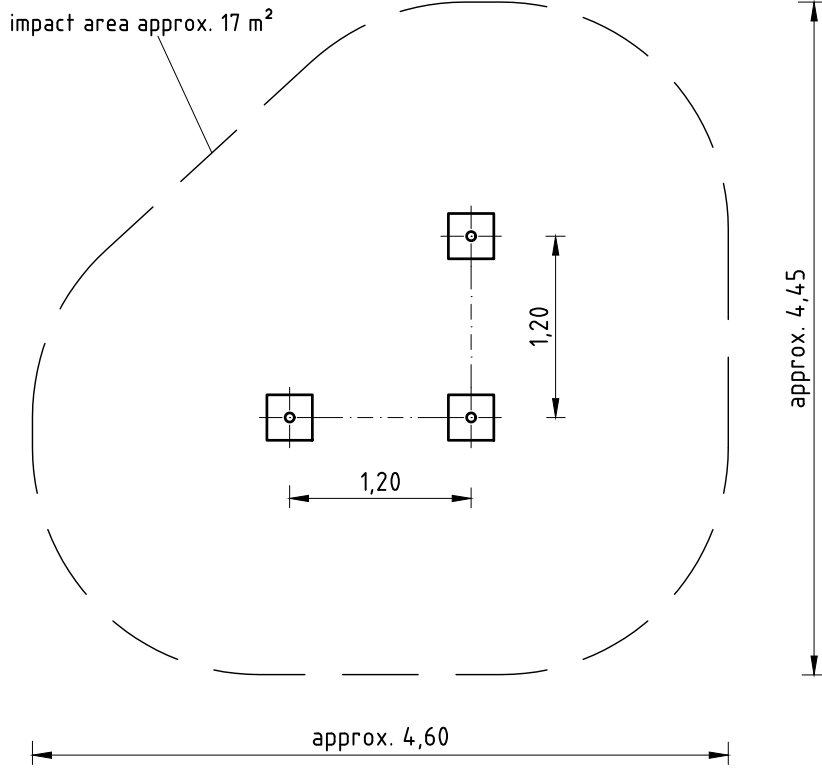
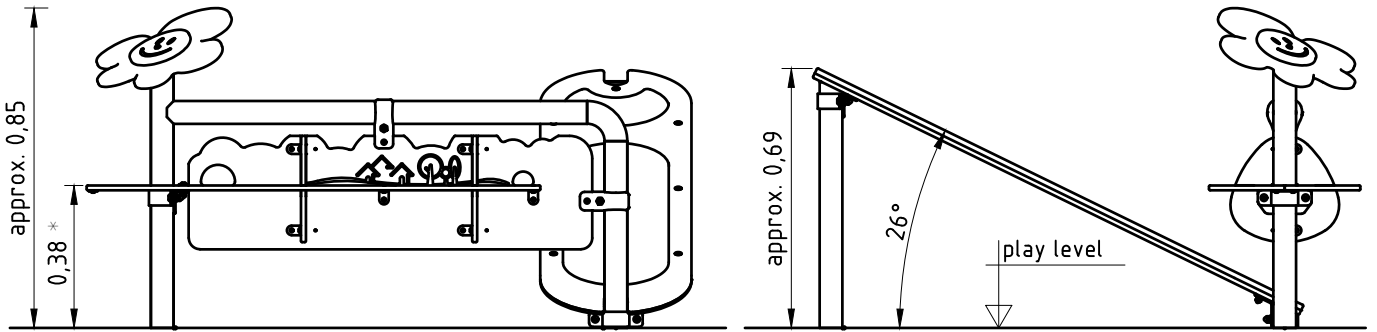

Installation

Item-No.	Description	Scale	Date	Page
0-39070-000	K&K Sand combination	1:50	11/18 GE	5/5

Item: **039070000**
 K&K Sand combination
 Location:

Order:

1292119

Building Project:

1 x SFWZ0000001 Security TORX wrench TR40

per SC	Total	K&K-Item	Marking
1 x	1 x	3490081	Security TORX wrench TR40



1 x SFWZ0000002 Security TORX wrench TR45

per SC	Total	K&K-Item	Marking
1 x	1 x	3490033	Allen key security TORX T45



1 x SFWZ0000003 Security TORX wrench TR30

per SC	Total	K&K-Item	Marking
1 x	1 x	3490080	Security TORX wrench TR30



1 x SFWZ0000006 Allen key security hex socket AF5

per SC	Total	K&K-Item	Marking
1 x	1 x	3490006	Allen key security hex socket AF5



Item: **039070000**

Order:

1292119

K&K Sand combination

Location:

Building Project:

**1 x SFWZ0000009 Hexagon insert socket driver 10mm 1/2"
with borehole for Pin**



per SC	Total	K&K-Item	Marking
1 x	1 x	2030170	Hexagon insert socket driver 10 mm 1/2" with drill hole for Pin

1 x SFWZ0000012 Lubricating metal (30g box) incl. brush



per SC	Total	K&K-Item	Marking
1 x	1 x	5300039	Lubricating metal box 30g
1 x	1 x	5200026	Brush for lubricating metal