

play equipment

## Play structure

item number

**022680701**

### **product description** (page 1)



#### Posts

Laminated Robinia timber Ø 120 mm with cylindrical milling. End-grain surfaces are covered by non-detachable protective stainless steel caps. Stainless steel tubular pedestal for concrete-cast foundation and for fixed mounting to round Robinia posts, Ø 120 mm, below playing surface.

#### Platforms

Platforms from boards of 30 mm thickness and all-round square-shaped joists 45 x 100 mm. Dried timber from Robinia, planed, milled and free from decay. Force-fitting fastening through specific stainless steel brackets with end-to-end bolt assembly.

#### Attachment parts

- tandem guardrails from stainless steel tubes, Ø 33,7 x 2 mm
- bowed guardrails with roll-off prevention, from stainless steel tubes, Ø 33,7 x 2 mm
- timber infill barrier from Robinia, 125 x 30 mm, fastening between stainless steel tubes Ø 33,7 x 2 mm
- climbing wall with 12 cut-outs from highly weather-resistant red HPL, 20 mm thickness, framed by stainless steel tubes
- vertical climbing pole from stainless steel tube Ø 38 mm
- climbing net from Hercules ropes suspended from stainless steel tandem crossbeam
- sloped scramble up net fixed to stainless steel crossbeam
- straight ladder rungs made from stainless steel tubes Ø 38 mm
- vertical handle from stainless steel tube Ø 33,7 x 2 mm, as a climbing aid
- sloped chain ladder with stainless steel rungs
- arch-shaped ladder from stainless steel tubes
- inclined ramp from Robinia timber with a tandem guardrail from stainless steel tubes with a fixed Hercules climbing rope Ø 18 mm
- plank bridge: V-shaped climbing net construction from Hercules ropes, Robinia footbridge with approx. 40 mm clear distance between the planks. Attachment to a steel frame construction. Barrier height approx. 0,75 m, stainless steel support posts Ø 20 mm
- horizontal monkey bars 0,80 x 2,40 m, from stainless steel tubes Ø 38 x 2,5/33,7 x 2 mm
- trough-shaped attachment slide, width 0,60 m, one-piece welded assembly, stainless steel sheet thickness: 2,5 mm, with roll-off prevention above the entrance section

play equipment

**Play structure**

item number

**022680701****product description** (page 2)

**For your planning, due to a possible sliding surface heating, please see to a north-east orientation of the slides or provide half-shade of trees.**

Robinia timber is furnished with water-repellent, breathable protective coating. Besides protection from moisture, that treatment reduces crack formation. Thanks to a specific fastening adaptor, forces arising from the modular attachment parts are directly derived into the posts. Tamper-proof connections thanks to protective screw caps.

play equipment

item number

## Play structure

**022680701**
<https://kaiser-kuehne.com/products/?lang=en>

### product data

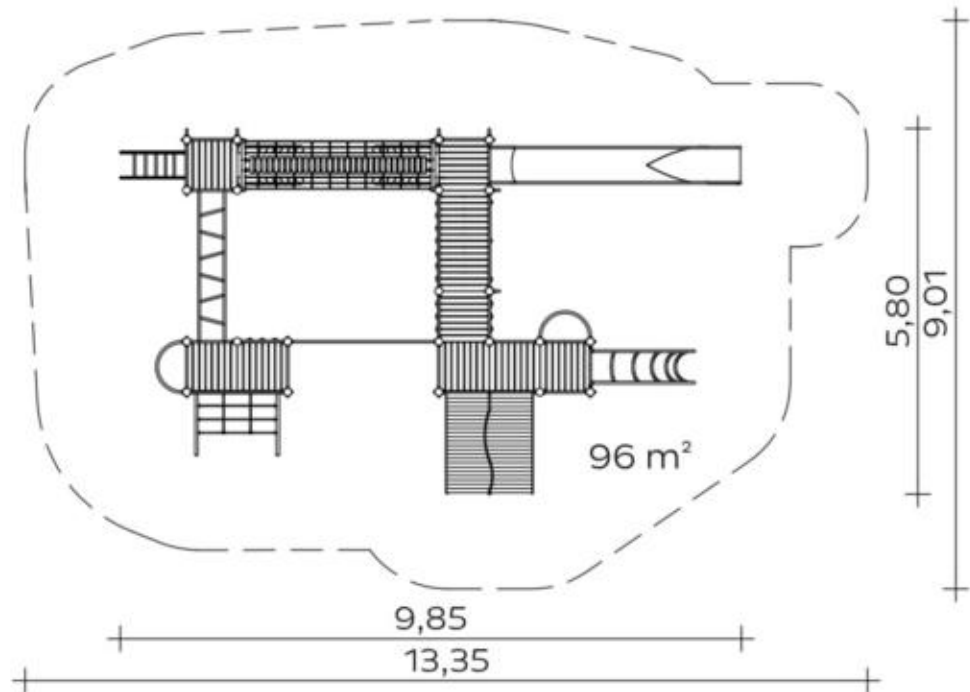

(without scale)

### installation

play equipment [m]	l	9,85
	w	5,80
	h	2,94
minimum space [m]	l	13,35
	w	9,01
	h	3,60
impact area [m²]		96,00
free height of fall [m]		2,72
number of mechanics		2
assembly time [hrs]		16
lifting device		no
single weight [kg]		170
total weight [kg]		1.630

### foundations

l [m]	w [m]	h [m]	vol [m³]	qty
0,40	0,40	0,40	0,064	22
1,00	0,60	0,60	0,360	2
0,30	0,30	0,40	0,036	7
0,75	0,40	0,40	0,120	1
			2,500	32

### usage

areas of use	public playgrounds		
activities	balancing climbing		motion activity sliding
age groups	4+		
number of users	42		
slide heights [m]	2,10		
platform heights	1,40	1,60	1,80 2,00
inclusion	Meeting opportunity		Drama play 
	Individual games		Functional play 
	Speed		Balancing 
	Group games		Altitude experience 
	Coordination		Parallel play 
	Self-awareness		

play equipment  
item number

## Play structure 022680701

### variants

16749 *Classic*



16750 *Sun*



26188 *Aloha*



26189 *Beach*



26190 *Coral*



26191 *Ice Palace*



26192 *Jungle*



26193 *Mermaid*



26194 *Nature*



26195 *Ocean*



26196 *Pirate*



26197 *Safari*



26198 *Sky*



26199 *Sunny Day*



26200 *Sweden*

