

play equipment

**Alpine Cabin**

item number

**020830701****product description** (page 1)Posts

Laminated Robinia timber Ø 120 mm with cylindrical milling. End-grain surfaces are covered by non-detachable protective stainless steel caps. Stainless steel tubular pedestal for concrete-cast foundation and for fixed mounting to round Robinia posts, Ø 120 mm, below playing surface.

Platforms

Platforms from boards of 30 mm thickness and all-round square-shaped joists 45 x 100 mm. Dried timber from Robinia, planed, milled and free from decay. Force-fitting fastening through specific stainless steel brackets with end-to-end bolt assembly.

Attachment parts

- Gable wall (1.60) closed: wooden parapet made of robinia 125 x 30 mm, fixed between stainless steel pipes Ø 33.7 x 2 mm
- Gable wall (1.60) with entrance and sign: wooden parapet made of robinia 125 x 30 mm, fixed between stainless steel pipes Ø 33.7 x 2 mm; central entrance opening with sign made of HPL plate
- Gable roof panels for fastening to gable walls, roof pitch 45°, made of highly weather-resistant HPL laminate panels (brown), 13 mm
- Wooden parapet made of robinia, 125 x 30 mm, fixed between stainless steel pipes Ø 33.7 x 2 mm
- Table made of highly weather-resistant HPL laminated board (red) 15 mm
- Seat made of highly weather-resistant HPL laminate (red), 20 mm

Metal components: stainless steel. Robinia timber is furnished with water-repellent, breathable protective coating. Besides protection from moisture, that treatment reduces crack formation. Thanks to a specific fastening adaptor, forces arising from the modular attachment parts are directly derived into the posts. Tamper-proof connections thanks to screws with protective screw cap.

play equipment

## Alpine Cabin

item number

**020830701**
<https://kaiser-kuehne.com/products/?lang=en>

### product data

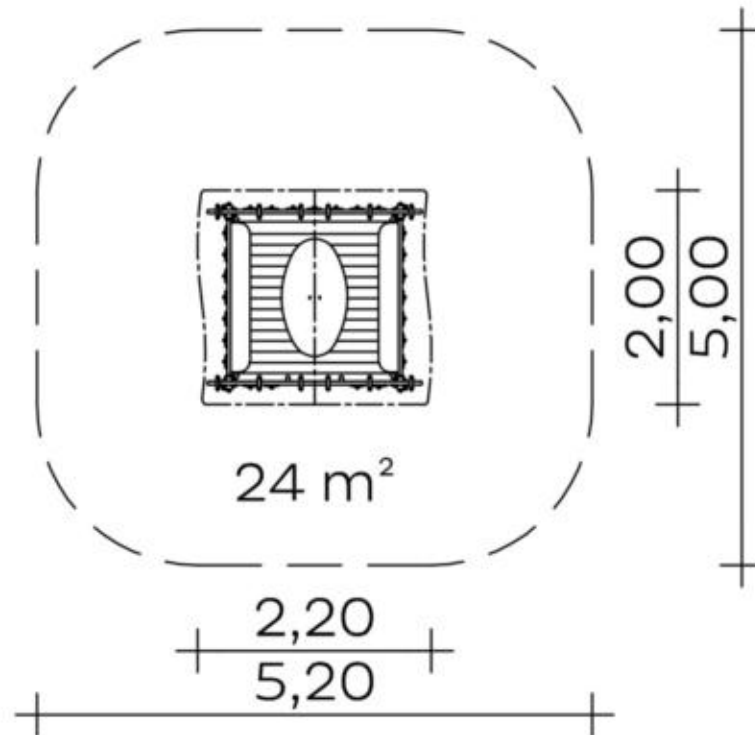

(without scale)

### installation

play equipment [m]	l	2,20
	w	2,00
	h	2,10
minimum space [m]	l	5,20
	w	5,00
	h	2,10
impact area [m²]		24,00
free height of fall [m]		0,20
number of mechanics		2
assembly time [hrs]		3
lifting device		yes
single weight [kg]		0
total weight [kg]		430

### foundations

l [m]	w [m]	h [m]	vol [m³]	qty
0,40	0,40	0,40	0,064	4
			0,256	4

### usage

areas of use	public playgrounds
activities	social activity
age groups	2+
number of users	6

platform heights 0,20

### inclusion

Meeting opportunity

Individual games

Communication

Drama play

Group games

Parallel play

play equipment  
item number

**Alpine Cabin**  
**020830701**

### variants

16598 *Classic*



16599 *Beach*



25228 *Aloha*



25229 *City*



25230 *Coral*



25231 *Ice Palace*



25232 *Jungle*



25233 *Mermaid*



25234 *Nature*



25235 *Ocean*



25236 *Pirate*



25237 *Safari*



25238 *Sky*



25239 *Sun*



25240 *Sunny Day*



play equipment

## **Alpine Cabin**

item number

**020830701**

### **variants**

25241 *Sweden*

