

play equipment

Drugstore

item number

020302500**product description** (page 1)Posts

Posts made from stainless steel tubes Ø 120 x 3 mm, covered by non-detachable protective stainless steel caps

Platforms

Platforms from boards of 30 mm thickness and all-round square-shaped joists 45 x 100 mm. Dried timber from Robinia, planed, milled and free from decay. Force-fitting fastening through specific stainless steel brackets with end-to-end bolt assembly.

Attachment parts

- infill panel from highly weather-resistant coloured HPL, 15 mm thickness
- timber infill barrier from Robinia, 125 x 30 mm, fastening between stainless steel tubes Ø 33,7 x 2 mm
- bowed guardrail with roll-off prevention, from stainless steel tube, Ø 33,7 x 2 mm
- saddle roof, 45° inclination, made from highly weather-resistant coloured HPL panels, 13 mm thickness, fastening to stainless steel frame Ø 33,7 x 2 mm
- table/awning: from highly weather-resistant coloured HPL, 15 mm thickness
- seat made from highly weather-resistant coloured HPL panel, 20 mm thickness

Metal components: stainless steel

Robinia timber is furnished with water-repellent, breathable protective coating. Besides protection from moisture, that treatment reduces crack formation. Thanks to a specific fastening adaptor, forces arising from the modular attachment parts are directly derived into the posts. Tamper-proof connections thanks to screws with security socket.

play equipment

item number

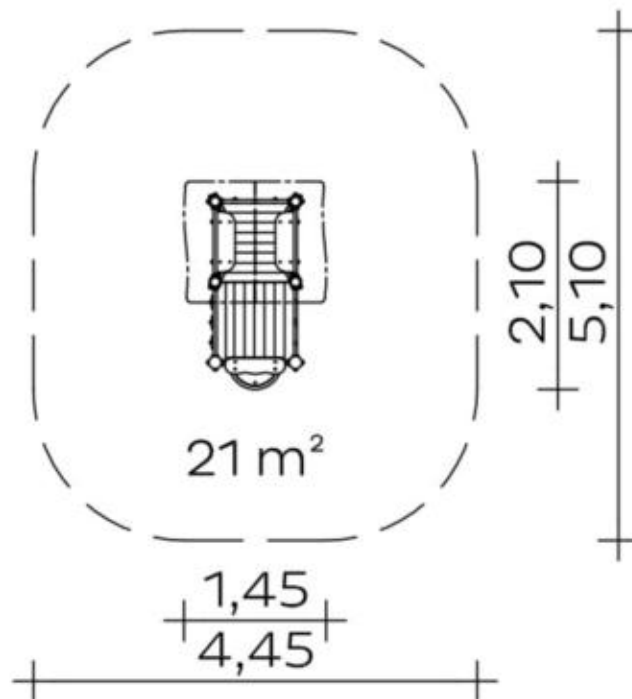
Drugstore
020302500
<https://kaiser-kuehne.com/products/?lang=en>
product data

(without scale)

installation

play equipment [m]	l	1,45
	w	2,10
	h	1,75
minimum space [m]	l	4,40
	w	5,05
	h	1,75
impact area [m²]		21,00
free height of fall [m]		0,55
number of mechanics		2
assembly time [hrs]		2
lifting device		no
single weight [kg]		30
total weight [kg]		260

foundations

l [m]	w [m]	h [m]	vol [m³]	qty
0,40	0,40	0,40	0,064	6
			0,384	6

usage

areas of use	public playgrounds
activities	social activity
age groups	1+
number of users	4

platform heights 0,20

inclusion

Meeting opportunity

Individual games

Communication

Drama play

Group games

Parallel play

play equipment
item number

Drugstore
020302500

variants

16588 *Classic*



18013 *Jungle*



20454 *Sun*



25145 *Aloha*



25146 *Beach*



25147 *City*



25148 *Coral*



25149 *Ice Palace*



25150 *Mermaid*



25151 *Nature*



25152 *Ocean*



25153 *Pirate*



25154 *Safari*



25155 *Sky*



25156 *Sunny Day*



play equipment

Drugstore

item number

020302500

variants

25157 *Sweden*

