

Instructions for maintenance

We recommend, in addition to our instructions for maintenance, to consider carefully the demands of EN 1176-7

K&K
Water table
0-33445-000 (0,25)

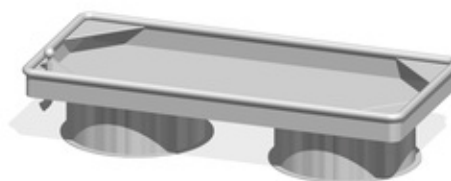

Check all screw connections; if necessary screw down again.

one-time only approx. 4-5 weeks after installation

Recommendations about regular maintenance



Check cleanliness of play- and safety area, take out alien elements

1 x weekly

2 x monthly

1 x monthly

4 x yearly

2 x yearly

1 x yearly



Check other component elements for wear and tight connections, tighten connections and replace defective elements if necessary



Check rubber parts like seats, hoses, collars etc. for wear, replace if necessary



Please note: The mentioned maintenance intervals are a recommendation only. They have to be adjusted to the needs and circumstances of a certain playground (e.g. due to the frequency of use, social facilities and vandalism problems etc.)