

play equipment

Water basin (0,25)

item number

033435000**product description** (page 1)

Welded structure made of stainless steel with two water outlets. Thickness of steel sheet: min. 2 mm / tube Ø 38 mm.

Anchorage by means of ring-shaped bottom flanges.

At extra charge, there are appropriate ring-shaped concrete foundations (015165) for flange fastening and concrete form blocks (015170) for masonry works to compensate different levels or for a safe installation with loose fall protection surfacing (sand, gravel etc.)

play equipment

Water basin (0,25)

item number

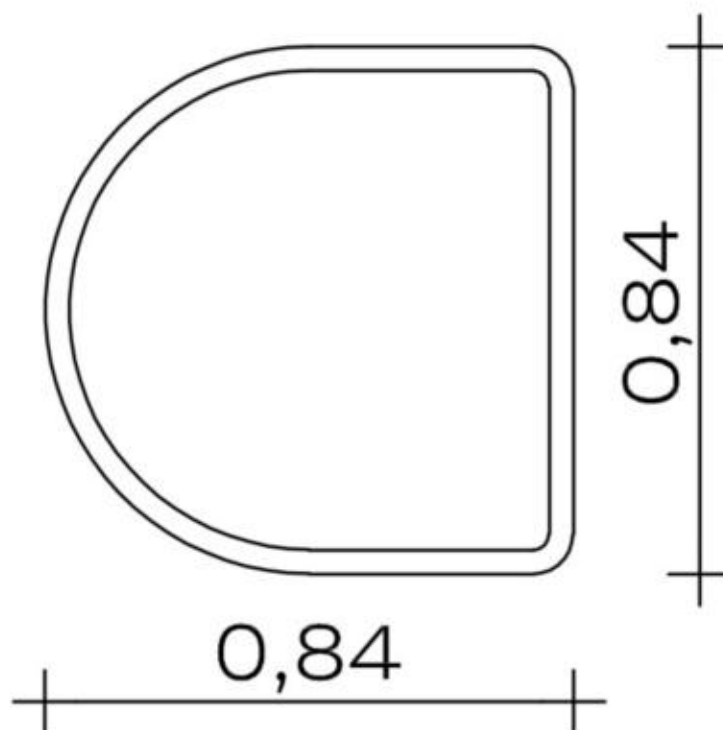
033435000
<https://kaiser-kuehne.com/products/?lang=en>
product data

(without scale)

installation

| | | |
|-------------------------|---|------|
| play equipment [m] | l | 0,84 |
| | w | 0,84 |
| | h | 0,40 |
| minimum space [m] | l | 3,84 |
| | w | 3,84 |
| | h | 0,40 |
| impact area [m²] | | 0,00 |
| free height of fall [m] | | 0,25 |
| number of mechanics | | 0 |
| assembly time [hrs] | | 0 |
| lifting device | | no |
| single weight [kg] | | 0 |
| total weight [kg] | | 45 |

usage

| | |
|--------------|--------------------|
| areas of use | public playgrounds |
| activities | |
| age groups | |

inclusion
foundations

| l [m] | w [m] | h [m] | vol [m³] | qty |
|-------|-------|-------|----------|-----|
| | | | 0,000 | 0 |

